

HABITAT - FIRST STREET

CITY OF WELLAND

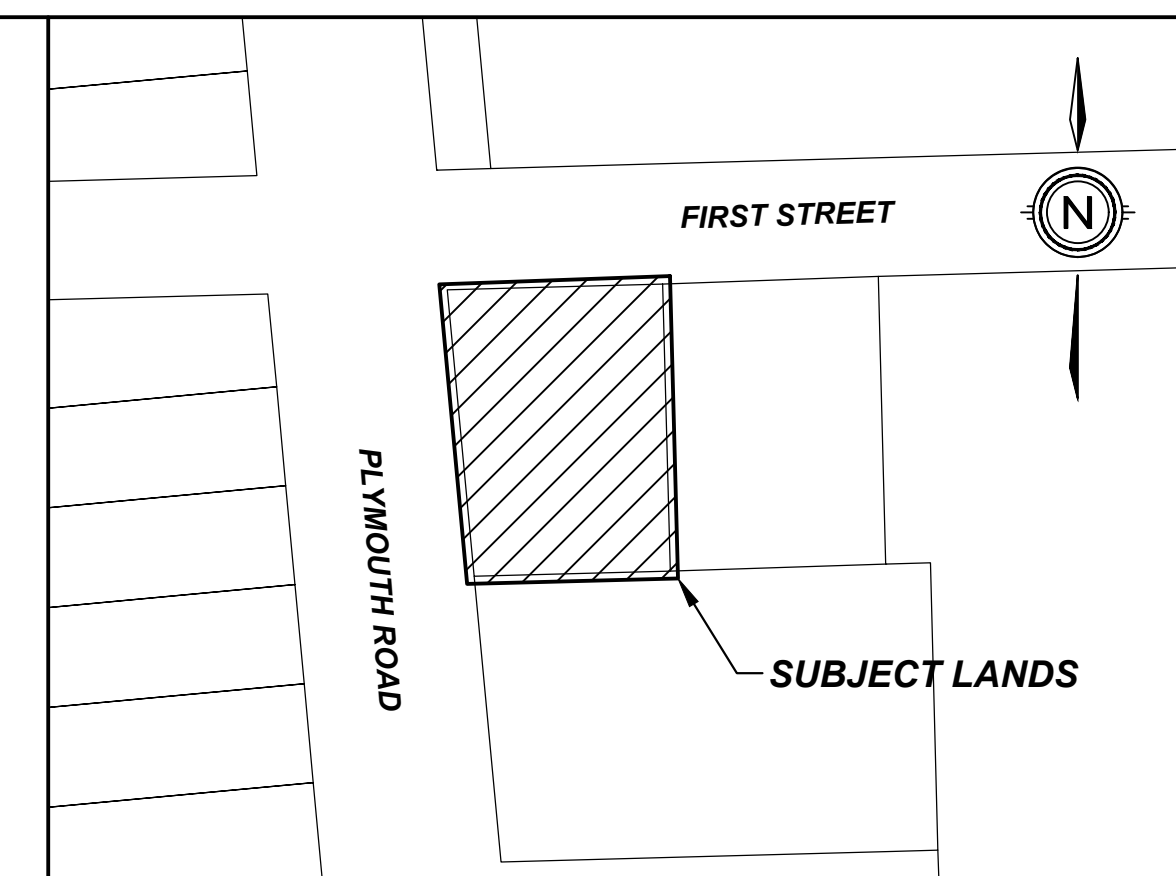
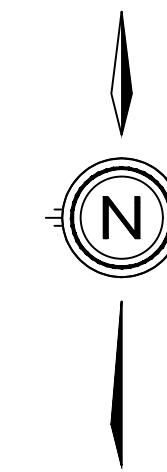

KEY PLAN

N.T.S.

LEGAL DESCRIPTION

PART OF THE ROAD ALLOWANCE
BETWEEN LOTS 24 AND 25
(GEOGRAPHIC TOWNSHIP OF CROWLAND)
AND PART OF BLOCK U, PLAN 564

OWNER'S CERTIFICATE

BEING THE REGISTERED OWNER, I HEREBY
AUTHORIZE UPPER CANADA CONSULTANTS TO
PREPARE AND SUBMIT THIS DRAFT PLAN OF
SUBDIVISION TO THE _____
FOR APPROVAL.

OWNER'S NAME _____ DATE _____

SURVEYOR'S CERTIFICATE

I HEREBY CERTIFY THAT THE BOUNDARIES OF
THE LANDS TO BE SUBDIVIDED ARE
CORRECTLY SHOWN.

SURVEYOR'S NAME _____ DATE _____

REQUIREMENTS OF SECTION 51(17) OF THE PLANNING ACT

- | | | |
|-------------|--------------------|-----------------|
| a) SEE PLAN | e) SEE PLAN | i) SILTY SAND |
| b) SEE PLAN | f) SEE PLAN | j) SEE PLAN |
| c) SEE PLAN | g) SEE PLAN | k) FULL SERVICE |
| d) SEE PLAN | h) MUNICIPAL WATER | l) SEE PLAN |

LAND USE SCHEDULE

LAND USE	LOT/BLOCK	# OF UNITS	AREA(m ²)	AREA(%)
SINGLE FAMILY RESIDENTIAL	LOT 1-6	6	917.82	53.86
TOTAL			1703.98	100.00

DEVELOPABLE AREA = 1703.98m²
DEVELOPABLE DENSITY = 35.21 units/ha

#	REVISION	DATE	INIT
0	ISSUED FOR REVIEW	YYYY-MM-DD	--



DRAFT PLAN	DRAWING TITLE	DRAFTING	NA
		DATE	JUNE 13, 2024
		PRINTED	FEBRUARY 21, 2025
		SCALE	1:250
	DWG No.	REV	
	1990-DP	0	